

Stereo Bluetooth Headset M109



User Manual

If there is any issue with your order,
please contact below email to ask for warranty

Email: support@pointcinco.com

Catalog

1.Product Overview-----	2
2.Basic Operation-----	3
3.Bluetooth Pairing and Connection-----	4
4.LED Indicator-----	5
5.TTS Tone-----	5
6.Charging-----	6
7.Product Specification-----	7
8.Attentions and Q & A-----	8
9.Warranty-----	9
10. USB Dongle User Manual-----	10

1.Product Overview

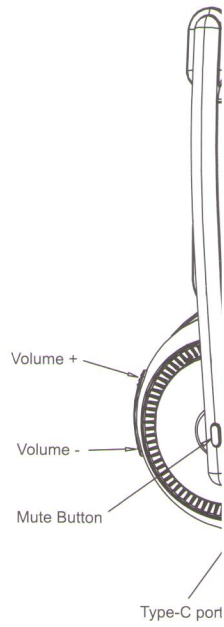

Packing list:

- A. Bluetooth headset
- B. Ear clip x 1
- C. Type-C charging cable
- User manual x 1

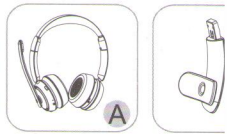

1.Product Overview

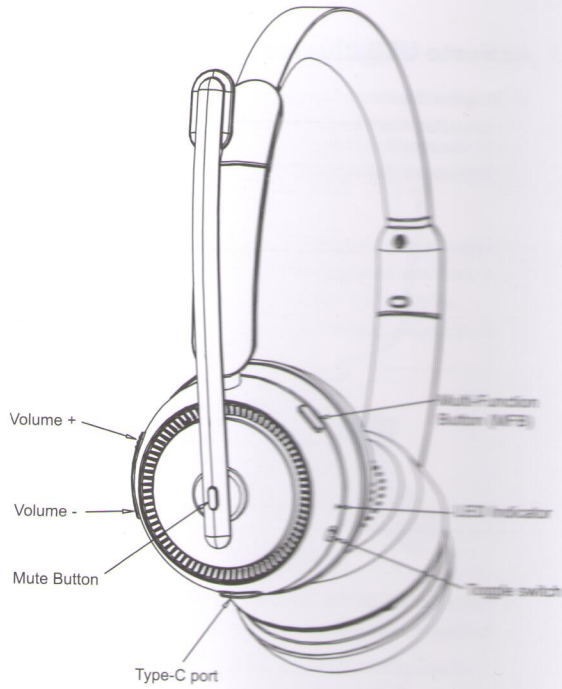

Packing list:

- A. Bluetooth headset M109 x 1
- B. Ear clip x 1
- C. Type-C charge cable x 1
- User manual x 1

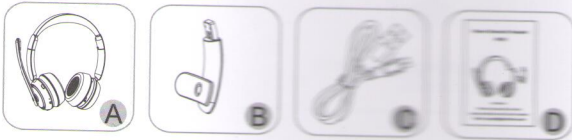

2.Basic Operation

Button	Function	Operation Instruction	
Toggle switch	Power On	Toggle the switch to the ON end, and M109 will automatically enter the pairing status, with prompt sound "Power ON".	
	Power Off	Toggle the switch to the ON end, and M109 will automatically enter the pairing status, with prompt sound "Power ON".	
	Enter Pairing Mode	a. Toggle the switch to the ON end, and enter pairing mode; b. Red and blue lights flicker alternately, with prompt sound "Pairing"; c. Manually disconnect the Bluetooth of the mobile phone, and the headset enters the matching mode.	
MFB	Redial A Call	In connected/music standby, double press "MFB" to dial the last call.	
	Voice Dialing	In connected standby mode, long press "MFB" for 1 second then release, with prompt "Du"	
	Answer a call	When a call incoming, short press "MFB" to answer.	
	Hang up a call	When during a call, short press "MFB" to hang up.	
	Reject a call	When a call incoming, long press "MFB" for 1 second to reject the call.	
	Play / Pause	Short press "MFB" when play music.	
	Audio Switch	When during a call, long press "MFB" for 1-2 seconds to switch, with prompt "Du"	
	Three-way calling function	1. Call coming during a call, short press "MFB" to answer a new call and hang up the current call; 2. Call coming during a call, double press "MFB" to answer a new call and keep the current call, with prompt "Du"; 3. Call coming during a call, long press "MFB" for 1 second to keep the current call and reject a new call, with prompt "Du"; 4. When you are on a three-party call, double press "MFB" to switch audio between the current call and the keep call, with prompt "Du".	
	Volume +	Volume Up	Short press. (the maximum with the prompt "Du")
		Next Song	Long press for 1 second.
Volume -	Volume Down	Short press. (the minimum with the prompt "Du")	
	Previous Song	Long press for 1 second.	
Mute Button	Microphone mute	When during a call, short press to mute, with prompt "mute on"; press again to cancel, with prompt "mute off"	

Combina
Buttor

3. B Con

- A. In c
to p
autc
- B. Sea
pho
"M1
from
- C. You
Mute
call
prev
micro



Combination Button	Delete Pairing records	In the power-on state (not allowed in the call state), press the "MFB" and "Volume-" for 5 seconds at the same time to clear the matching records. If it is cleared, the connected devices cannot be reconnected. You need to repair again.
--------------------	------------------------	---

3. Bluetooth Pairing and Connection

- In off status, toggle the switch to the On end to power on, M109 will enter pairing mode automatically.
- Search and click to connect "M109" on your phone Bluetooth lists, the mobile phone shows "M109 Connected", now you can play music from phone to headphone.
- You can press MFB / Volume+ / Volume- / Mute Button to control the answer/hang up a call and play/pause of the music, next and previous song, volume up and down, microphone mute, etc.

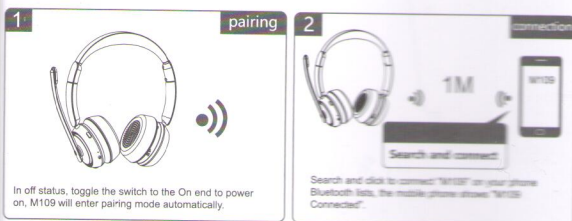

4. LED Indicator

Mode	LED Indicator
Power on	Blue LED flashes 2 times
Power off	Red LED flashes 2 times
Pairing mode	Red & Blue LED flash alternately
Delete pairing records	Red LED is on for 1 second
Connected standby mode	Blue LED flashes once every 10 seconds
Music	Blue LED flashes twice every 10 seconds
Talking	Blue LED flashes once every 10 seconds
Charging	Solid Red LED
Full charged	Solid Blue LED
Low battery	Red LED flashes

5. TTS Tone

Mode	Prompt
Power on	Power on
Power off	Power off
Enter pairing mode	Pairing
Microphone mute on	mute on
Microphone mute off	mute off
Low Battery	Low battery please charge
Disconnect	Your headset is disconnected
Connect successfully	Your headset is connected

6. Charging

Please charge the
Charging time is at
when full charged.

Charge Connection

Please connect to t
through the Type-C
cable, and connect
charger (car charge
USB, etc).

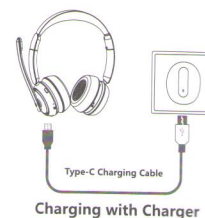

*Note:

Please charge the M
2 months when don'

4. LED Indicator

Mode	LED Indicator
Power on	Blue LED flashes 2 times
Power off	Red LED flashes 2 times
Pairing mode	Red & Blue LED flash alternately
Delete pairing records	Red LED is on for 1 second
Connected standby mode	Blue LED flashes once every 10 seconds
Music	Blue LED flashes twice every 10 seconds
Talking	Blue LED flashes once every 10 seconds
Charging	Solid Red LED
Full charged	Solid Blue LED
Low battery	Red LED flashes

5. TTS Tone

Mode	Prompt
Power on	Power on
Power off	Power off
Enter pairing mode	Pairing
Microphone mute on	mute on
Microphone mute off	mute off
Low Battery	Low battery please charge
Disconnect	Your headset is disconnected
Connect successfully	Your headset is connected

-05-

6. Charging

Please charge the M109 when Red LED flashes. Charging time is about 2 hours. Solid Blue Led when full charged.

Charge Connections

Please connect to the "M109" charging port through the Type-C head of the Type-C charging cable, and connect the USB head to the USB charger (car charger, travel charger, computer USB, etc).

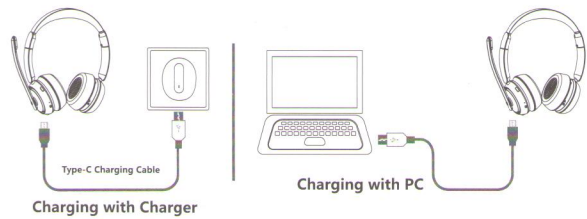

*Note :

Please charge the M109 at least one time every 2 months when don't use it.

-06-

7. Product Specification

Bluetooth Version	Bluetooth V5.2
Bluetooth Chipset	8925B2
Operation Range	10 meters
Bluetooth Protocols	HSP HFP A2DP AVRCP
Code	AAC SBC
Battery	400mAh /3.7V
Charging Time	About 2 hours
Standby Time	About 400 hours
Music Time	About 45 hours (70% volume)
Talk Time	About 40 hours (70% volume)
Headset Net Weight	About 202g
Headset Dimension	186.6*187.2*69mm

*The above data are all from SKY WING laboratory, and the actual use time will vary with different environment and music.

8. Attentions and Q & A

A. How to reconnect and operation when failed to reconnect?

When M109 connect with your mobile phone successfully at the first time, it will search and reconnect the paired device automatically when power on. If failed, please pair and connect again. You can click the name of the headset "M109" in the Bluetooth pairing list of your mobile phone to connect, or press the "MFB" and "Volume-" for 5 seconds at the same time to clear the matching record of the headphone and then reconnect it with the mobile phone.

B. How to delete paired records?

In the power on status (not allowed in the call state), press "MFB" and "Volume -" Button for 5 seconds at the same time to clear the pairing record. If the red light is on for 1 second, the matching records of M109 can be cleared. The connected devices are no longer connected. When various connection exceptions occur, you can try to clear the pairing records.

C. What is the password for pairing?

Some connection devices require password for

pairing, please try 0000 or 8888 or 1111 or 1234.

D. What devices could charge for the headphone?

Any car charger, power bank, PC etc. which meet DC 5V, charging current more than 500mA could charge M109.

9. Warranty

If there is any issue with your order, please contact below email to ask for warranty, and **you don't have to return the defective one to amazon.**

Email: support@pointcinco.com

PS: We provide warranty even though the return window was closed.

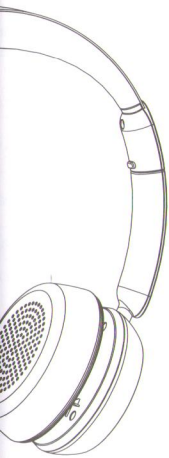

ono
o connect
ongle.

01

1. Activate USB Bluetooth Dongle

- 1) Plug the Bluetooth Dongle into a USB port on your computer, it will be turned on automatically.

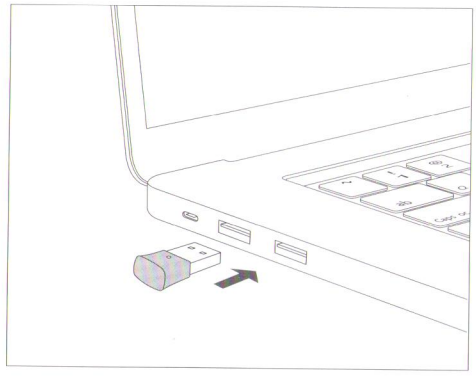

- 2) Once turned on, the indicator on the Dongle will flash quickly in blue indicating it is in pairing mode now.

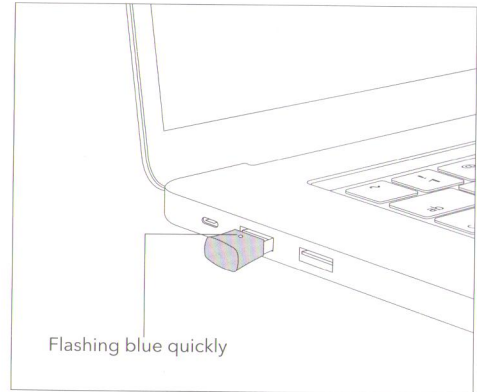

02

2. Initial Pairing M109 with Bluetooth Dongle

Before pairing, please disable the Bluetooth function on your phone/computer previously connected with M109 .

- 1) Press and hold the Multifunction Button on M109 for 3 seconds to bring the headset into Auto Re-pairing mode with the LED indicator flashing blue.
- 2) Dongle will connect with the headset automatically.

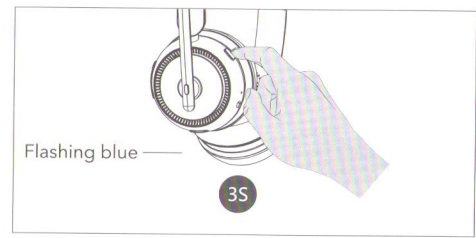

Once connected, the indicator on the Dongle will stay solid blue. The indicator on the headset will flash blue.

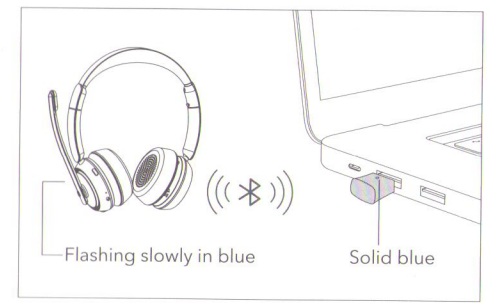

03

3. Automatic Re-pairing

M109 can remember the Dongle paired previously. After being paired successfully for the first time the Bluetooth Dongle is plugged in the computer then turn on M109 .

4. Using Headset with Dongle and Phone/Computer for Calls

1. Make sure the Dongle is plugged in and the function on your phone/ computer is enable turning on M109 .
2. Play music and make call on the PC, laptop, the headset can hear music and call.

5. Troubleshooting

Q: The Bluetooth Dongle won't turn on after into the USB port.

A: Try another USB port. After being plugged in the Dongle will power on automatically and the indicator flashes blue quickly.

Q: The Bluetooth Dongle doesn't pair with M109.

A: Please make sure the Bluetooth Dongle is in pairing mode and M109 is in auto re-pairing mode, wait them to pair automatically.

Q: The Bluetooth Dongle won't auto-reconnect with M109.

A: Please make sure you plug in the Dongle firmly and turn on M109 .

If there is any issue with your order, please contact us to ask for warranty, and **you don't have to return the product to amazon.**

Email: support@pointcinco.com

PS: We provide warranty even though the return is closed.